

FDZNAUX2



**Purpose**

The SoundGate FDZNAUX2 lets you connect a Zune™ digital media player directly to the factory radio in the vehicles listed below. The FDZNAUX2 supplies power, charges your Zune device, and allows for remote control of all Zune device functions (remote sold separately).



**Features**

The SoundGate FDZNAUX2 utilizes sophisticated microprocessor control, ultra-reliable surface-mount construction, and advanced software design to flawlessly integrate with factory audio systems. Your Zune device's audio can be selected from your factory radio's controls.

**The FDZNAUX2 works in the following vehicles:**

VEHICLE	YEAR	AUDIO SYSTEM	VEHICLE	YEAR	AUDIO SYSTEM
<b>FORD</b>			Navigator	1999-02	CD changer capable
Crown Victoria	1998-02	CD changer capable	Town Car	1998-02	CD changer capable
Econoline	1998-05	CD changer capable	<b>MAZDA</b>		
Excursion <sup>1</sup>	2000-05	CD changer capable	Pickup	1995-03	CD changer capable
Expedition	1997-98	4- or 7-speaker	<b>MERCURY</b>		
Expedition <sup>2</sup>	1999-02	CD changer capable	Grand Marquis	1998-02	CD changer capable
Explorer	1995-97	without JBL system	Marauder	2003-04	CD changer capable
Explorer	1998	CD/cassette combo	Mountaineer	1997-98	without JBL system
Explorer	1999-03	CD changer capable	Mountaineer	1998	CD/Cassette combo
F150/F250	1999-04	CD changer capable	Mountaineer	1999-03	CD changer capable
F150/F250 Heritage	1997-07	CD changer capable	Tracer	1997-02	CD changer capable
F250/F550SD	1999-04	CD changer capable	Villager <sup>5</sup>	1999-02	CD changer capable
HN-80 Truck	1997	CD changer capable	<b>NISSAN</b>		
Ranger <sup>3</sup>	1995-03	CD changer capable	Quest <sup>5</sup>	1996-02	CD changer capable
Windstar	1999-02	CD changer capable			
<b>LINCOLN</b>					
Continental <sup>4</sup>	1998-03	CD/Cassette combo			
LS	1999-02	CD changer capable			

<sup>1</sup> Without rear DVD  
<sup>2</sup> Some early 2003 Expeditions use the connectors in this package while later 2003 Expeditions require the SoundGate FDPDAUX1.  
<sup>3</sup> Not compatible with Ranger Tremor  
<sup>4</sup> For 2003, the vehicle must be pre-wired for CD changer and will require the SoundGate FDPDAUX1.  
<sup>5</sup> Without factory video system

Check [www.soundgate.com](http://www.soundgate.com) for the most current compatibility information.

Simple-fi.™

[www.soundgate.com](http://www.soundgate.com)

Rev 20080715

If you experience problems, call SoundGate Technical Support at +1-800-256-0808, or email us at [sgtech@soundgate.com](mailto:sgtech@soundgate.com).

**WARNING**

**DO NOT DISASSEMBLE OR ALTER**

Doing so may result in an accident, fire, or electric shock.

**Do not block your view**

Do not mount product or any added audio/video equipment where it can block your view through the windshield or block your view of dashboard indicators and displays.

**Do not block safety devices**

Do not mount product or any added audio/video equipment where it can obstruct the operation of any safety device, such as the airbag.

**Distraction warning**

Do not allow product or any added audio/video equipment to distract you while you are driving.

**BEFORE WIRING, DISCONNECT THE CABLE FROM THE NEGATIVE BATTERY TERMINAL**

Before starting any installation work, wait 90 seconds after turning the ignition switch to the LOCK position and disconnecting the negative (-) terminal from the battery. The supplemental restraint system (SRS), or airbag(s) is equipped with a backup power source. If installation work is started less than 90 seconds after disconnection of the negative (-) battery terminal, the SRS may deploy. When the negative (-) terminal cable is disconnected from the battery, the clock and audio systems' memory may be erased. Before starting installation work, make a record of the clock and audio systems' memory settings. When installation is complete, reset the clock and audio systems to their previous settings. Power tilt, power telescopic steering column, power seats, power mirrors, power shoulder belt anchorage, and other power accessories may or may not be equipped with a memory function; consider keeping a record of these settings as well.

When installation is complete, readjust the features to their previous settings.

Never use a backup power supply (such as another battery) during installation work in an attempt to avoid losing these memory settings.

**CAUTION**

**DO NOT ALLOW CABLES TO BECOME ENTANGLED IN SURROUNDING OBJECTS**

Cables or wiring that obstruct or get caught on places such as the steering wheel, shift lever, brake pedals, etc. can be extremely hazardous.

**DO NOT INSTALL IN LOCATIONS WITH HIGH MOISTURE OR DUST**

Moisture or dust may result in product failure.

**HAVE THE WIRING AND INSTALLATION DONE BY EXPERTS**

The wiring and installation of this product requires special technical skills and experience.

**USE ONLY SPECIFIED ACCESSORY PARTS**

Use of other than specified parts may damage product internally.

**FOLLOW THE OPERATIONAL AND INSTALLATION MANUALS.**

YOU SHOULD READ AND FAMILIARIZE YOURSELF THOROUGHLY WITH THE FOLLOWING INFORMATION PRIOR TO INSTALLING AND USING THIS UNIT. IN ADDITION, YOU MUST CAREFULLY READ AND FOLLOW THE INSTALLATION SCHEMATICS AND INSTRUCTIONS FOR THE PRODUCT AND THE VEHICLE IN WHICH IT IS BEING INSTALLED. FAILURE TO FOLLOW INSTALLATION INSTRUCTIONS MAY DAMAGE THE PRODUCT AND THE VEHICLE, WILL VOID THE PRODUCT WARRANTY, AND MAY VOID THE VEHICLE WARRANTY.

**TROUBLESHOOTING**

Should this product fail to operate properly, please contact your Dealer or SoundGate Technical Support via email at [sgtech@soundgate.com](mailto:sgtech@soundgate.com) or via phone at +1-800-256-0808.

**FDZNAUX2 Overview**

**RCA component A/V outputs.** Connect the audio outputs to the matching locations of the FDZNAUX2 components on the next page.

Yellow = Video  
 Red = Audio Right  
 White = Audio Left

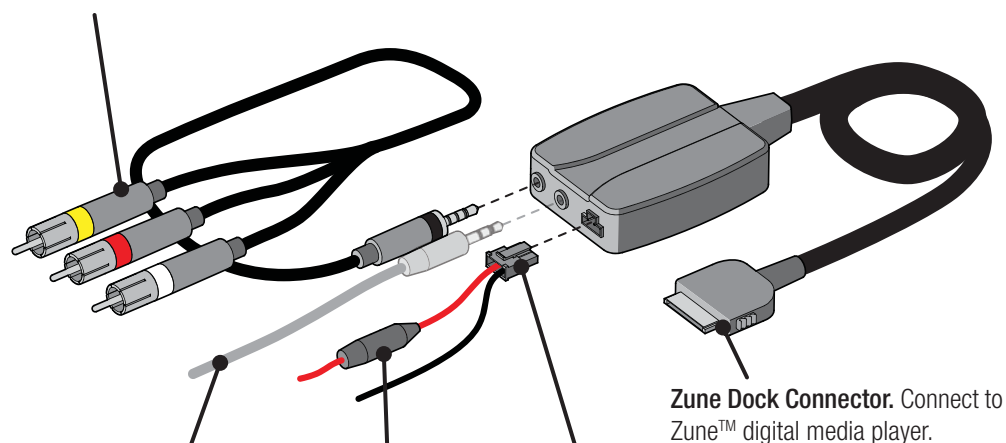

**Optional remote control (available separately).** Allows full control of a connected Zune device's functions.

**Power connector.** Connect black wire to bare-metal chassis. Connect red wire to a +12V switched (ignition) power source.

**Inline fuse.** The red wire of the power connector is fused to protect your Zune device and vehicle systems. This wire requires a 12V, 1500mA fuse.

Connect the RCA Left (white) and Right (red) audio cables (from the component-set on page 2) to the FDZNAUX2 module.

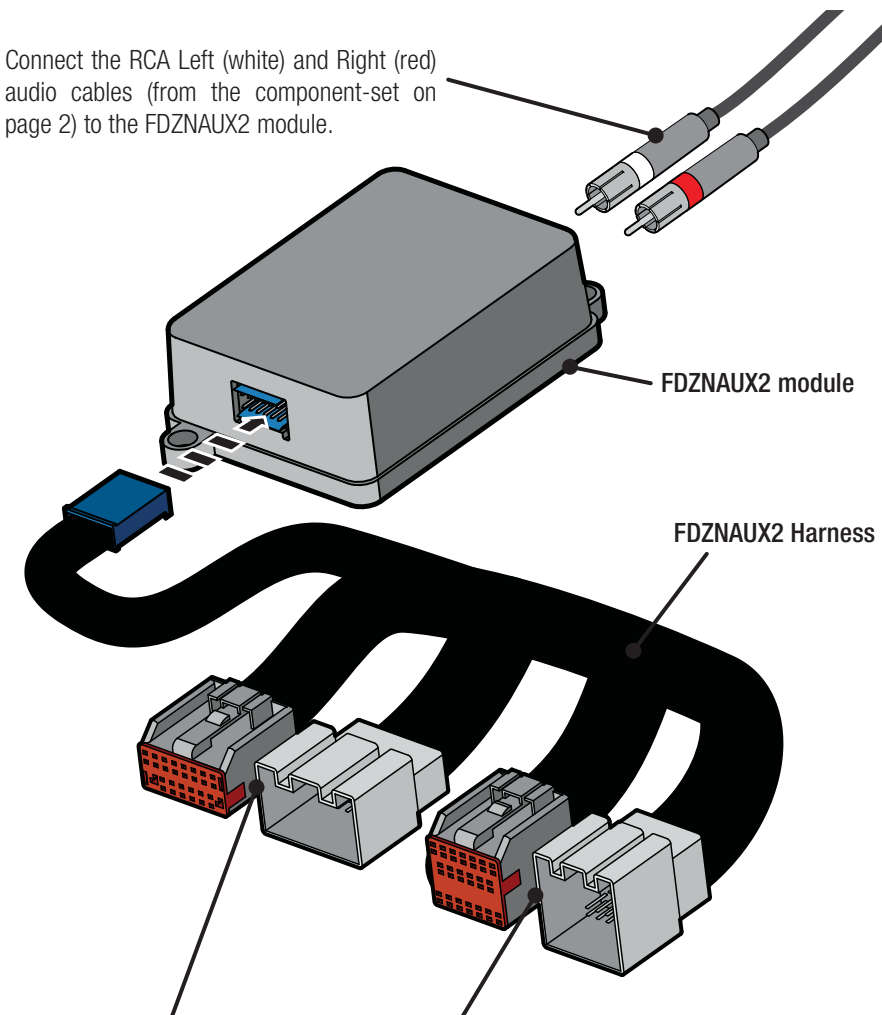

**14-pin Male/Female and 20-pin Male/Female connectors.** Connect these to the matching locations on your factory radio. See the instructions on page 4 for further details.

**BEFORE YOU BEGIN:**

1. Turn the ignition off.
2. Ensure the factory radio is turned off.

**Installation**

**STEP 1** Gain access to the factory radio's rear panel. The FDZNAUX2 connects directly to the rear panel of the factory radio. Full or partial disassembly of the dash will be necessary. Use a "DIN tool" to remove the factory radio. If you are unsure of this procedure, please consult a factory service manual or have the work performed by a mobile electronics specialist. Pay special attention to warnings or instructions regarding working near airbags, other safety devices, or security systems.

**STEP 2** Connect the FDZNAUX2 harness to the factory radio. After exposing the rear panel of the factory radio, disconnect the factory connectors.

Plug **BOTH** male connectors of the FDZNAUX2 harness into the matching locations on the factory radio's rear panel. Connect the factory connectors you disconnected from the radio into the matching female connectors on the FDZNAUX2 harness.

**STEP 3** Assemble the components shown on page 2 and connect them to the FDZNAUX2 module. Use the diagrams on pages 2–3 to assemble the components that will connect to and control your Zune device.

**Power connector wiring.** Connect the black wire of the power connector shown on page 3 to a clean, bare-metal chassis ground. When in doubt, measure the resistance between potential grounding points and the vehicle battery using a multimeter. Choose a grounding point with equivalent resistance as other grounded components in the audio system. Connect the red wire to a +12V switched (ignition) power source. This wire requires a 12V, 1500mA inline fuse. **MAKE CERTAIN THAT REPLACEMENT FUSES MATCH THESE SPECIFICATIONS.**

**STEP 4** Mount all components. Mount the FDZNAUX2 module behind or under the dash (mounting hardware not included). Be careful not to drill into wiring or vehicle mechanisms. You are solely responsible for securely fastening the FDZNAUX2 in your vehicle. Make certain that wires and cables cannot be damaged by screws, clips, or sharp, exposed pieces of metal.

Ensure that the Zune dock connector is left in a convenient place for connection to your Zune device. Plug the Zune dock connector in straight. Do not insert the connector at an angle or wiggle the connector during insertion.

**Controlling your Zune device**

The FDZNAUX2 will not provide control of your Zune device unless you attach the optional remote, which is available separately. Please visit [www.soundgate.com](http://www.soundgate.com) or your local mobile audio dealer for details on the FDZNAUX2 remote's availability.

**Activating the FDZNAUX2**

To activate the FDZNAUX2, select the CD changer function on your factory radio. Please refer to the factory radio operation manual that came with your vehicle for specific details on how to select the CD changer function.

**IMPORTANT**

After installation, test for correct operation by following these steps:

1. Turn on the radio and press the **FM** button. Next, press the **CD** button to test for proper operation (make sure you have music playing on your Zune device).

*If at this point the radio displays **NO DJ** or **NO CDDJ**, do the following:*

2. Leave the radio on.
3. Disconnect the blue connector from the FDZNAUX2 module. Wait 30 seconds.
4. With the radio still on, reconnect the blue connector and press the **CD** button.

**Why SoundGate Dealers have the edge...**

The technologies used in today's vehicles are as sophisticated as any laptop computer. At SoundGate we believe these new technologies are full of opportunities for mobile electronic dealers across the nation. We make it a high priority to not only research these new systems, but to understand them and their impact on the aftermarket car audio industry. Armed with this knowledge, we are well equipped to help you integrate new components into these systems with our innovative, high-performance interfaces and unparalleled technical support.

**Ask your autosound specialist about these other exciting SoundGate products...**

- Auxiliary Input Interfaces and Docking Stations which allow you to input audio from MP3 Players, DVD/Video, Satellite Radio, and more to OEM and aftermarket car audio systems
- High-performance Radio Replacement
- Interfaces for seamlessly integrating new receivers or CD players into OEM audio systems
- Competition-Grade Interfaces for adding amplifiers
- Remote Audio Control Interfaces that let you control aftermarket receivers and CD players from your factory rear seat, or steering-wheel mounted audio controls.
- And many others!

Simple-fi.™

[www.soundgate.com](http://www.soundgate.com)

Zune™ and the Zune™ logo are trademarks of the Microsoft group of companies.

Copyright© 2004-2008 SoundGate®. All Rights Reserved. SoundGate® is a registered trademark of Stillwater Designs, Inc. All other trademarks are the property of their respective owners.